

# STEP

## APPLICATIONS

Fixed recessed luminaire of the Step series are compact single-LED products particularly suitable as an outdoor steplight. Being installed on walls, this product can be used to mark steps and walkways, for decorative warning purposes. Thanks to the specific flange designed for an asymmetrical distribution of the beam, this product delivers efficient and soft illumination of the ground surface ensuring maximum comfort. Step is strongly characterized by linear and essential design, which interact harmoniously with any type of setting, making it a unique and distinctive product. All fixtures are already equipped with a connection cable for a flawless installation, extendable on request.



## FEATURES

High efficiency (>120 lm/W)

ANSI compliant binning

Excellent lumen maintenance and colour stability over time

Extensive dimming range - fully dimmable, with external dimmer

Highly efficient secondary optics

IP67 protection rating

Suitable for wall mounting

Long life and low maintenance costs

Ecological, no disposal restrictions

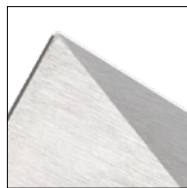

Flange

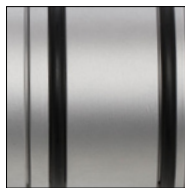

O-Ring



Cable gland

## STEP

### SPECIFICATIONS

#### Performance

LED type	High power
LED nr. and model	1xCree XP-E o XP-G
Total lumen output (at 85°C)	Up to 220 lm
Colour temperature (white light)	2800 - 3200 - 4200 - 5500 K
Binning	2 step MacAdam ellipses
CRI	>90 (2800 - 3200 K), >80 (4200 - 5500 K)
Other colours	On request

#### Electrical

Supply type	Constant current / constant voltage
Supply value	700 mA / 24 Vdc
Maximum power consumption	2,4 W
Connection	Cable 2x0.5 mmq L=2 m

#### Physical

Body material	Anti-corrosion aluminium
Body finish	Anodization
Optic material	PMMA
Optic type	Diffuse
Screen material	6 mm thick extra-clear tempered glass
Dissipation	Passive
Protection rating	IP67
Class	III
Weight	0,2 Kg
Dimensions	See technical drawing
Operating temperature range	-20 / +70 °C
MTBF (LM80)	50.000 hrs
Mounting	Wall recessed with mounting sleeve

### HOW TO ORDER

Model	Supply	Colour
▼	▼	▼
STP	---	---
STP Step	700 700 mA 724 700 mA @24 Vdc	WW2 Warm white 2800K WW3 Warm white 3200K NW4 Neutral white 4200K CW5 Cold White 5500K

Order code example: **STP-700WW2**

TECHNICAL DRAWING

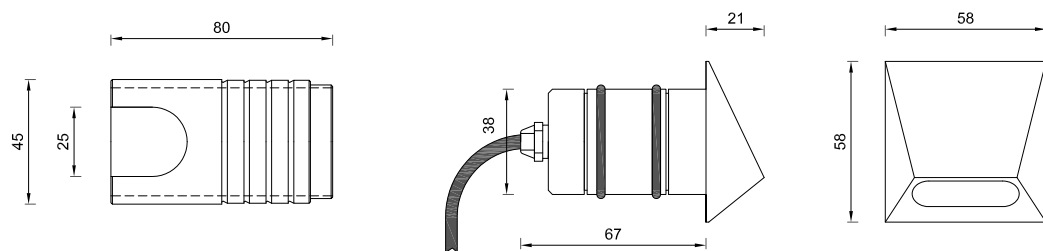

ACCESSORIES

Cables

2-pole power supply cable extra length L=2 m (tot. 4 m, monochromatic)	CABLO202P
2-pole power supply cable extra length L=4 m (tot. 6 m, monochromatic)	CABLO402P
2-pole power supply cable extra length L=6 m (tot. 8 m, monochromatic)	CABLO602P
2-pole power supply cable extra length L=8 m (tot. 10 m, monochromatic)	CABLO802P
2-pole power supply cable extra length L=10 m (tot. 12 m, monochromatic)	CABL1002P

Mounting kit

Concrete sleeve (corrosion-resistant aluminium)	TRN00164
---	----------







Flanges

V4A stainless steel flange	TRN00385
Brass flange	TRN00475

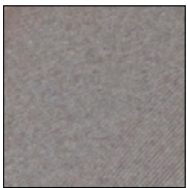
Watertight connections

IP68 Paguro 5665 Junction box - 2x2,5 sqmm - parallel connection	CMP00850
IP68 Paguro 5664/20 Junction box - 4x2,5 sqmm - parallel connection	CMP00852

Finishes (to be combined to the relative flanges)

			
Dark brown anodized aluminium ALL-BRZ	Mirror polished stainless steel ACC-L	Brushed stainless steel ACC-S	Mirror polished brass OTT-L
			
Light antiqued brass OTT-C	Dark antiqued brass OTT-A	Mirror polished gold GLD-L	